

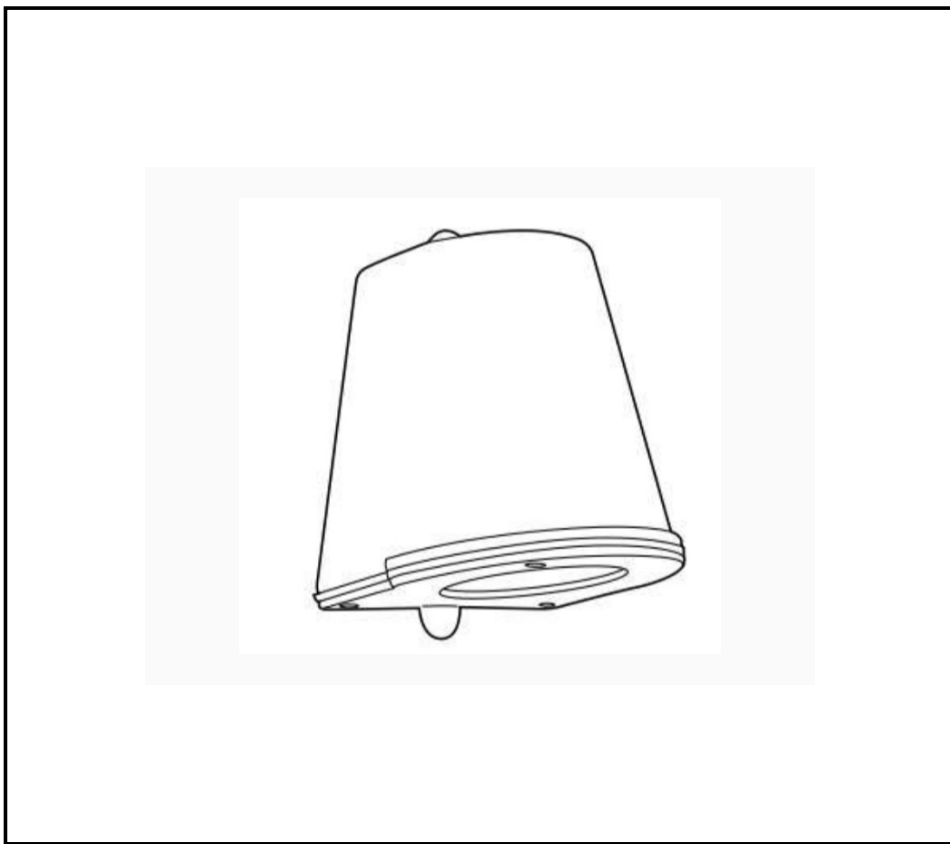

Navigator



Mast Wall Light Installation Guide

Applies to models: 09733, 09734, 09735

Components

1x Light fitting.

1x GU10 lampholder

2x wall plugs

2x cable insulators

2x screws

Electrical safety warning

- Always disconnect the main power before starting any electrical work.
- Ensure the installation site is isolated and safe.
- All work must comply with IET Wiring Regulations (BS7671).
- If the product is not double insulated, it must be earthed.
- Electrical installations should be carried out by a Competent Person or someone with relevant experience, and in accordance with the appropriate Competent Person Scheme.
- The circuit must be protected by a Residual Current Device (RCD) that is functioning correctly and has been tested by a qualified electrician.
- Before installing the lighting unit, consult safety guidance from the Health and Safety Executive.

Installation Instructions

IMPORTANT: If you are unsure at any point, STOP and seek professional assistance. Do not proceed unless you are confident.

1. Ensure the electricity supply is switched off at the fuse board before starting any work.
2. Use a screwdriver to remove the screws connecting the lamp cover (net) to the base.
3. Open the base to access the internal wiring.
4. Feed the supply cable through the rear cable gland. The gland is designed for one 3-core supply cable (1.5mm²). This fitting does not support loop-in/loop-out wiring.
5. Prepare and trim the conductors as required. Inside the fitting is a floating 3-pole connector block (Live, Neutral, Earth). This block is not fixed; once wiring is complete, position it neatly behind or to the side of the lamp.
6. Make the electrical connections as follows:
 - i. Earth (green/yellow) → Earth terminal of the connector block
 - ii. Neutral (blue) → N terminal of the connector block
 - iii. Live (brown) → L terminal of the connector block
7. Only one conductor per terminal may be connected. Ensure all connections are tight and that no loose strands are exposed.
8. The internal wiring is heat-resistant and is designed to run next to the lamp body. We recommend the use of LED GU10 lamps, which produce significantly less heat than halogen alternatives.
9. Insert the GU10 lamp (max 40W, LED recommended).
10. Refit the lamp access lid, ensuring the seal is correctly seated to maintain the IP65 rating.
11. Restore power and test the fitting.

The manufacturer bears no responsibility for any injury or damage resulting from incorrect installation or use of the product.

Wiring Diagram

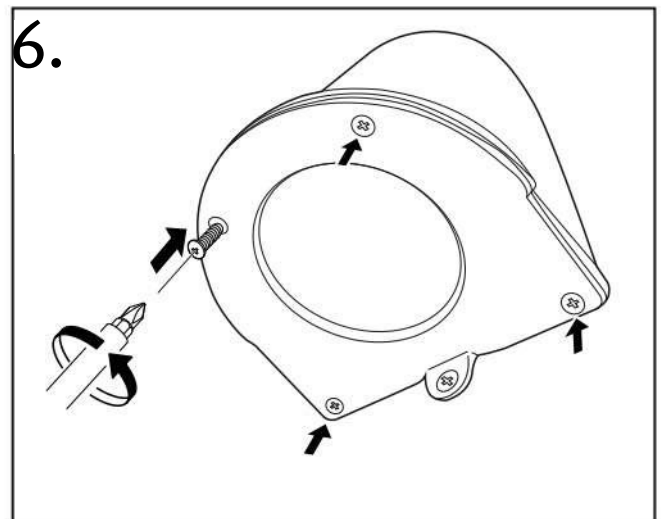
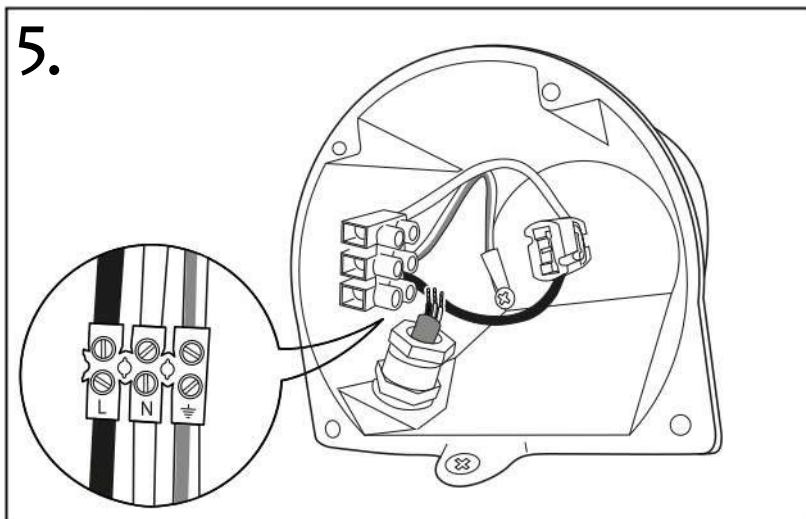
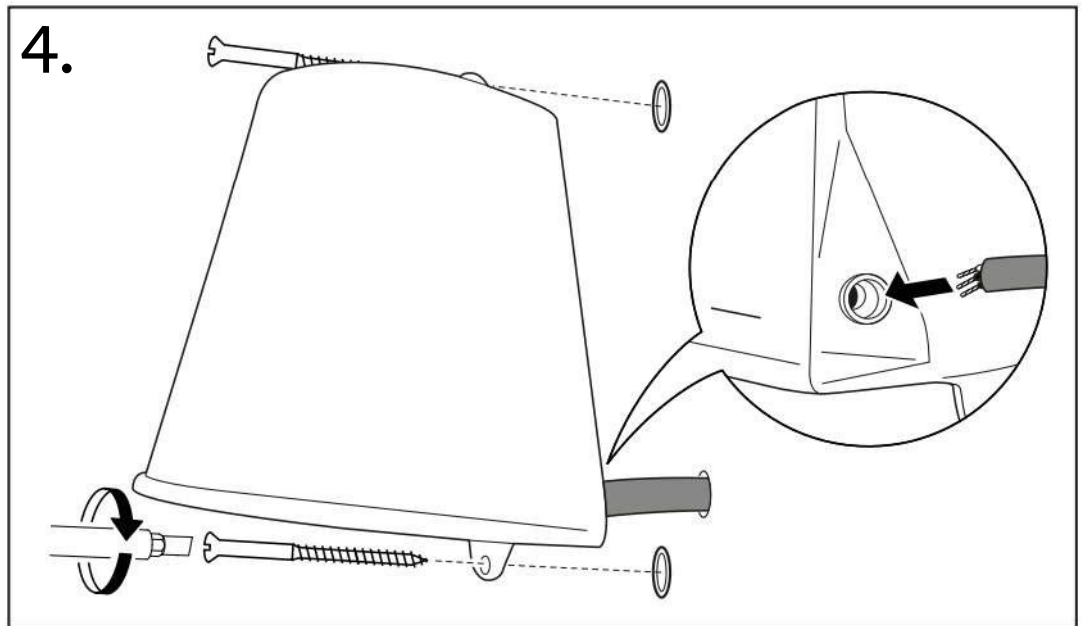
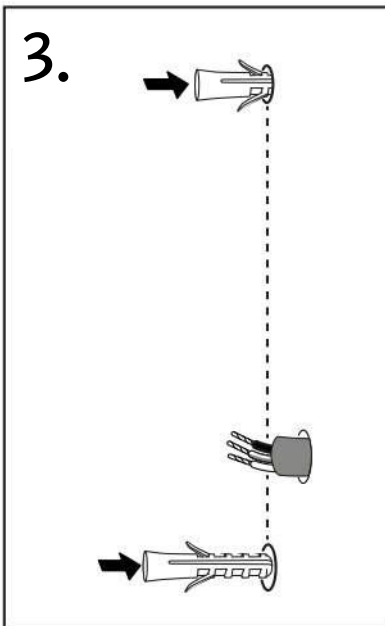
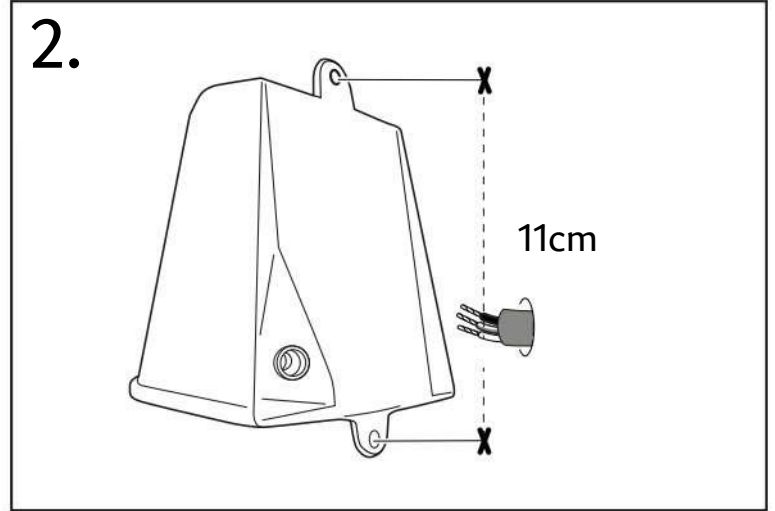
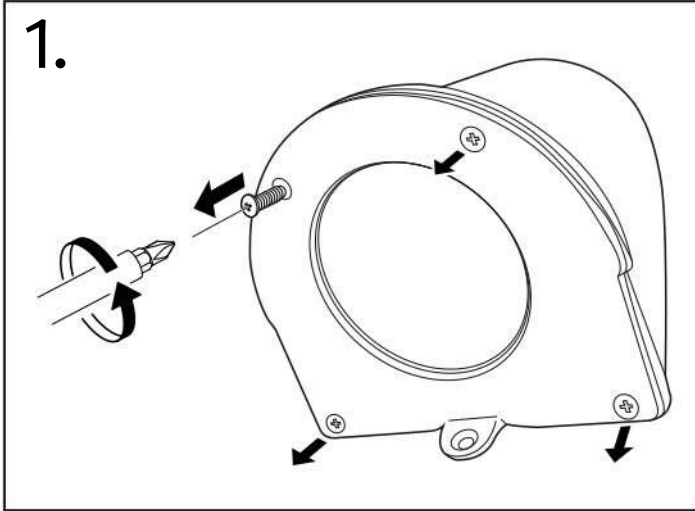

Navigator Lighting (Part of Lampfix)